

THIS DRAWING IS UNPUBLISHED. RELEASED FOR PUBLICATION  
 © COPYRIGHT - By - ALL RIGHTS RESERVED.

LOC		DIST		REVISIONS			
P	LTR	DESCRIPTION		DATE	DWN	APVD	
AA	20	P		PER ECO-13-016325	18OCT13	BL	JY

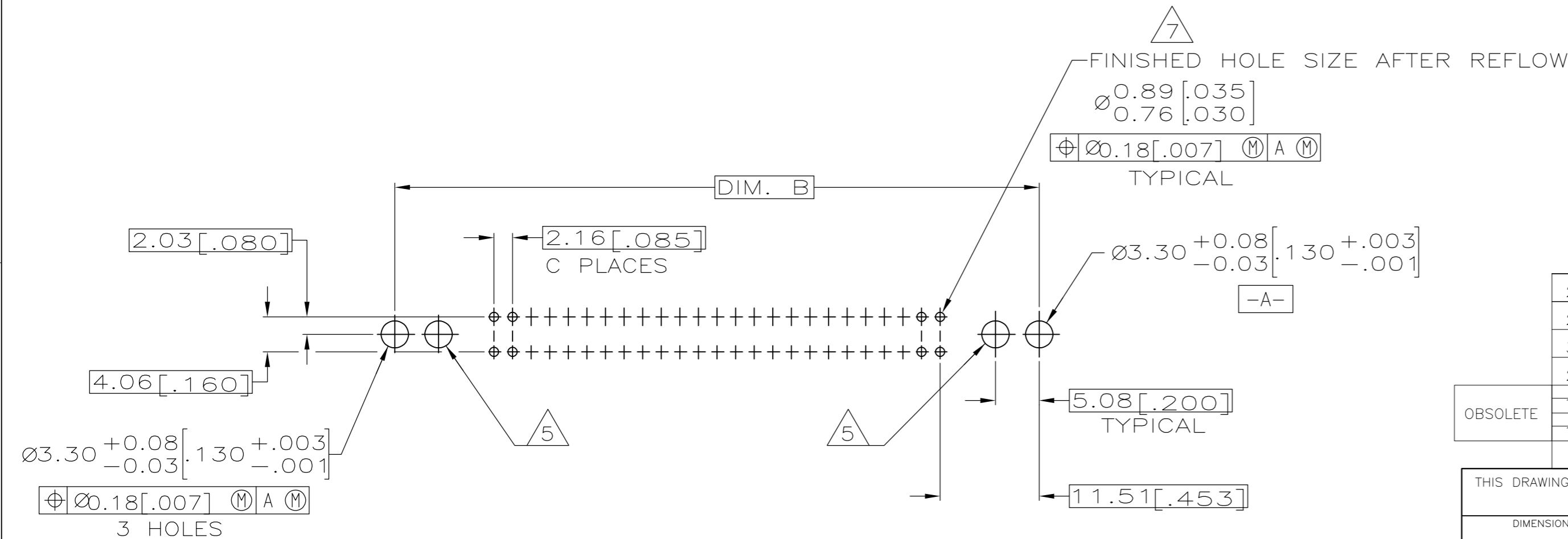
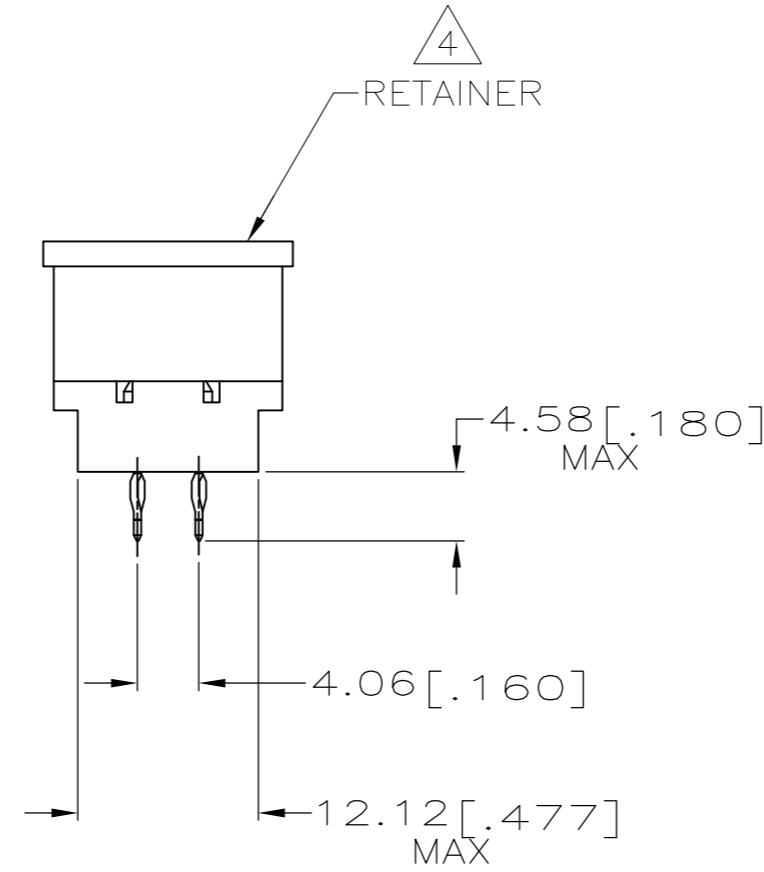
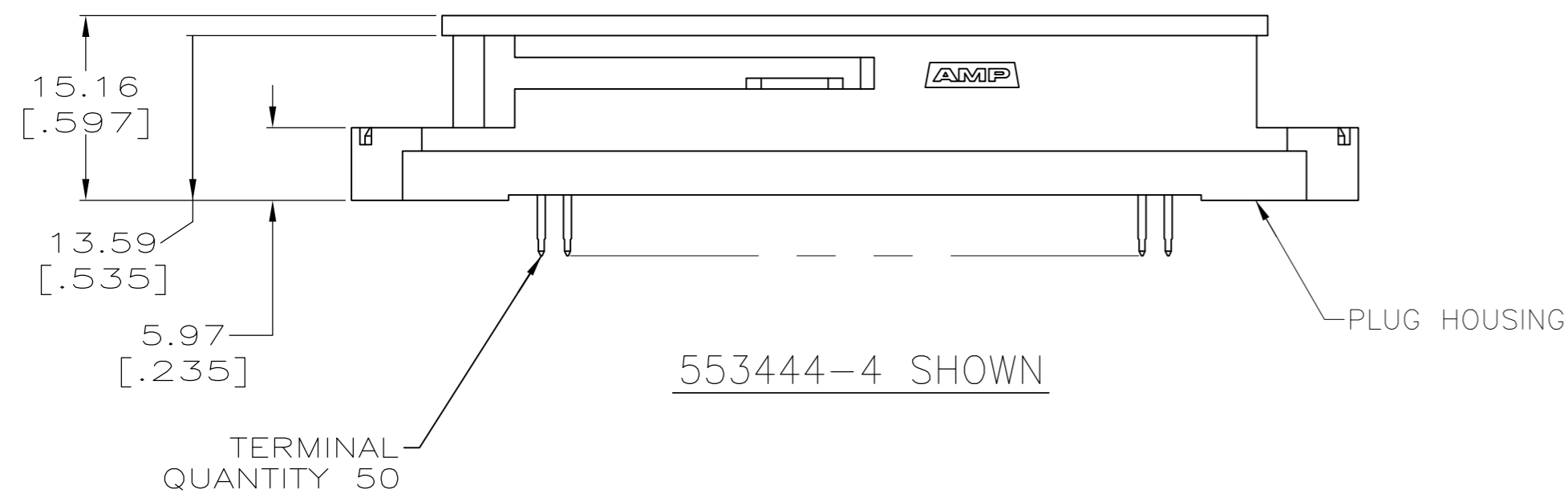
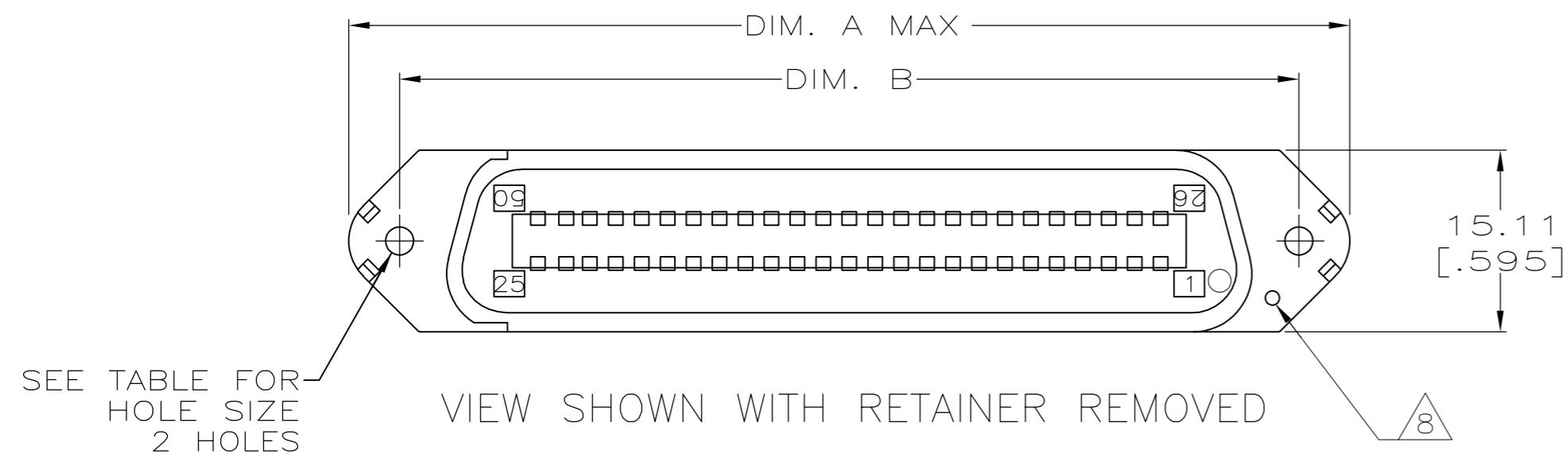

PRINTED CIRCUIT BOARD MOUNTING DIMENSIONS

- 1 MATERIAL: HOUSING - POLYESTER MOLDING COMPOUND BLACK.  
 TERMINAL - COPPER ALLOY PLATED WITH 0.76µm [.000030] MINIMUM THICK GOLD ON MATING SURFACE AND 0.13µm [.000005] MINIMUM THICK GOLD ON ACTION PIN AREA OVER 1.27µm [.000050] MINIMUM THICK NICKEL UNDERPLATE OVER ENTIRE TERMINAL.  
 RETAINER - POLYETHYLENE, NATURAL.
- 2. THE CONTACT SURFACES OF THE TERMINALS ARE COATED WITH LUBRICANT.
- 3 ALL DIMENSIONS SHOWN ARE FOR REFERENCE ONLY UNLESS OTHERWISE SPECIFIED.
- 4 RETAINER MUST REMAIN INSTALLED UNTIL AFTER CONNECTOR HAS BEEN INSERTED INTO PCB HOLES.
- 5 OPTIONAL MOUNTING HOLE FOR SELF-TAPPING SCREW.
- 6. CENTER-TO-CENTER SPACING OF TERMINALS IS 2.16 [.085] NOMINAL.
- 7 ALL PLATED-THRU HOLES SHALL BE PER AMP SPEC 115-6072.
- 8 THRU HOLE ON HOUSING FLANGE INDICATES POSITION 1 LOCATION.
- 9 MATERIAL: HOUSING - POLYESTER MOLDING COMPOUND BLACK.  
 TERMINAL - COPPER ALLOY PLATED WITH 0.76µm [.000030] MINIMUM THICK GOLD ON MATING SURFACE AND 2.54µm [.0001] MINIMUM THICK TIN ON ACTION PIN AREA OVER 1.27µm [.000050] MINIMUM THICK NICKEL UNDERPLATE OVER ENTIRE TERMINAL.  
 RETAINER - POLYETHYLENE, NATURAL.

24	3.18[0.125]	74.83[2.946]	83.31[3.280]	9	9	50	553444-9
24	3.18[0.125]	74.83[2.946]	83.31[3.280]	1	1	50	553444-8
31		89.97[3.542]	98.43[3.875]	1	1	64	553444-5
24	4-40 UNC-2B	74.83[2.946]	83.31[3.280]	1	1	50	553444-4
17		59.74[2.352]	68.20[2.685]	1	1	36	553444-3
11		46.79[1.842]	55.25[2.175]	1	1	24	553444-2
C	HOLE SIZE	DIM. B	DIM. A	FINISH	MATERIAL	POSITION	PART NUMBER

THIS DRAWING IS A CONTROLLED DOCUMENT.

DWN	05 APR 85	TE Connectivity
CHK	05 JUN 85	
APVD	05 JUN 85	
PRODUCT SPEC		
DIMENSIONS: mm TOLERANCES UNLESS OTHERWISE SPECIFIED: 0 PLC ± - 1 PLC ± - 2 PLC ± - 3 PLC ± - 4 PLC ± - ANGLES ± - FINISH		NAME PLUG ASSEMBLY, ACTION PIN, CHAMP-LOK
MATERIAL		SIZE A2
WEIGHT		CAGE CODE 00779
CUSTOMER DRAWING		DRAWING NO 553444
SCALE		RESTRICTED TO -
SHEET		1 of 1
REV		P